

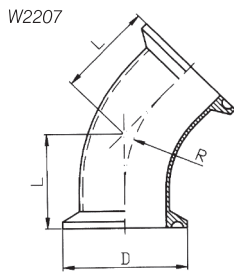

# DIN 卡箍式管件

## DIN Clamp Pipe Fittings



W2207  
DIN 卡箍式弯头 (45° )  
DIN Clamp Elbow (45° )

Size	D	L	R
DN10	34	28.7	26
DN15	34	32.5	35
DN20	34	34.5	40
DN25	50.5	42.2	50
DN32	50.5	44.3	55
DN40	50.5	46.3	60
DN50	64	50.5	70
DN65	91	61.2	80
DN80	106	65.3	90
DN100	119	69.5	100
DN125	144.5	115.5	187
DN150	167	131.2	225

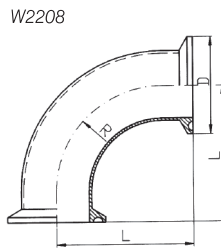

W2208  
DIN 卡箍式弯头 (90° )  
DIN Clamp Elbow (90° )

Size	D	L	R
DN10	34	44	26
DN15	34	53	35
DN20	34	58	40
DN25	50.5	71.5	50
DN32	50.5	76.5	55
DN40	50.5	81.5	60
DN50	64	91.5	70
DN65	91	108	80
DN80	106	118	90
DN100	119	128	100
DN125	144.5	225	187
DN150	167	263	225
DN200	217.5	338	300

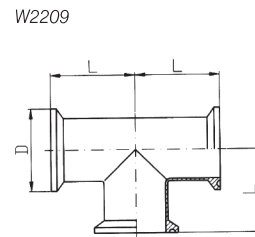

W2209  
DIN 卡箍式三通  
DIN Clamp Tee

Size	D	L
DN10	34	44
DN15	34	53
DN20	34	58
DN25	50.5	71.5
DN32	50.5	76.5
DN40	50.5	81.5
DN50	64	91.5
DN65	91	108
DN80	106	118
DN100	119	128
DN125	144.5	225
DN150	167	263

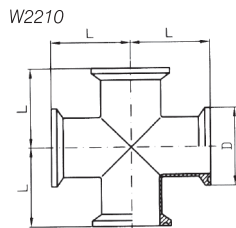

W2210  
DIN 卡箍式四通  
DIN Clamp Cross

Size	D	L
DN10	34	44
DN15	34	53
DN20	34	58
DN25	50.5	71.5
DN32	50.5	76.5
DN40	50.5	81.5
DN50	64	91.5
DN65	91	108
DN80	106	118
DN100	119	128
DN125	144.5	225
DN150	167	263

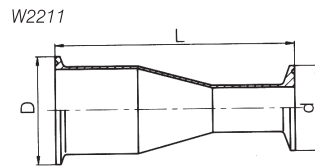

W2211  
DIN 卡箍式同心大小头  
DIN Clamp Concentric Reducer

Size	D	d	L
DN20-DN15	34	34	86
DN25-DN20	50.5	50.5	86
DN32-DN20	50.5	50.5	106
DN32-DN25	50.5	50.5	106
DN40-DN20	50.5	34	128
DN40-DN25	50.5	50.5	128
DN40-DN32	50.5	50.5	128
DN50-DN25	64	50.5	141
DN50-DN32	64	50.5	141
DN50-DN40	64	50.5	141

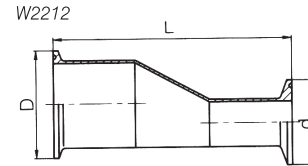

W2212  
DIN 卡箍式偏心大小头  
DIN Clamp Eccentric Reducer

Size	D	d	L
DN65-DN25	91	50.5	151
DN65-DN32	91	50.5	151
DN65-DN40	91	50.5	146
DN65-DN50	91	64	146
DN80-DN40	106	50.5	166
DN80-DN50	106	64	151
DN80-DN65	106	91	146
DN100-DN50	119	64	192
DN100-DN65	119	91	159
DN100-DN80	119	106	152

## INCH 卡箍式管件 INCH Clamp Pipe Fittings

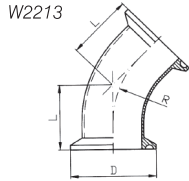

INCH 卡箍弯头 (45°)  
INCH Clamp Elbow (45°)

Size	D	L	R
1/2"	25.4	20.6	19.1
3/4"	25.4	24.5	28.5
1"	50.5	28.5	38.1
1 1/4"	50.5	32.5	47.7
1 1/2"	50.5	36.5	57.2
2"	64	44.5	76.2
2 1/2"	77.5	52.4	95.3
3"	91	60.3	114.3
4"	119	79.3	152.4
6"	167	116.9	228.6

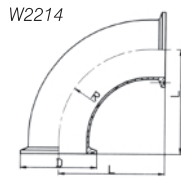

INCH 卡箍弯头 (90°)  
INCH Clamp Elbow (90°)

Size	D	L	R
1/2"	25.4	31.8	19.1
3/4"	25.4	41.3	28.5
1"	50.5	50.8	38.1
1 1/4"	50.5	60.3	47.7
1 1/2"	50.5	69.9	57.2
2"	64	88.9	76.2
2 1/2"	77.5	108	95.3
3"	91	127	114.3
4"	119	168.2	152.4
6"	167	250.8	228.6

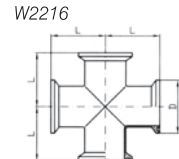
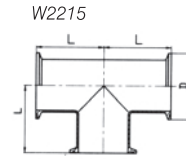

INCH 卡箍三通 / 卡箍四通  
INCH Clamp Tee/Clamp Cross

Size	D	L
1/2"	25.4	50.8
3/4"	25.4	50.8
1"	50.5	60.3
1 1/4"	50.5	67.7
1 1/2"	50.5	69.9
2"	64	88.9
2 1/2"	77.5	88.9
3"	91	95.3
4"	119	114.3
6"	167	149.2

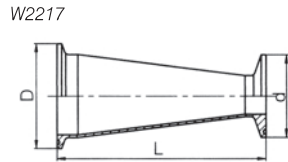

INCH 卡箍式同心大小头  
INCH Clamp Concentric Reducer

Size	D	d	L
0.75"/0.5"	25.4	25.4	50.8
1"/0.5"	50.5	25.4	63.5
1"/0.75"	50.5	25.4	50.8
1.5"/0.5"	50.5	25.4	88.9
1.5"/0.75"	50.5	25.4	76.2
1.5"/1"	50.5	50.5	76.2
2"/0.5"	64	25.4	139.7
2"/0.75"	64	25.4	127
2"/1"	64	50.5	127
2"/1.5"	64	50.5	76.2
2.5"/0.5"	77.5	25.4	190.5
2.5"/0.75"	77.5	25.4	177.8
2.5"/1"	77.5	50.5	177.8

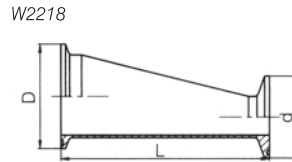

INCH 卡箍式偏心大小头  
INCH Clamp Eccentric Reducer

Size	D	d	L
2.5"/1.5"	77.5	50.5	127
2.5"/2"	77.5	64	76.2
3"/1"	91	50.5	228.6
3"/1.5"	91	50.5	177.8
3"/2"	91	64	127
3"/2.5"	91	77.5	76.2
4"/1"	119	50.5	333.4
4"/1.5"	119	50.5	282.6
4"/2"	119	64	231.8
4"/2.5"	119	77.5	181
4"/3"	119	91	130.2
6"/3"	167	91	193.7
6"/4"	167	119	193.7

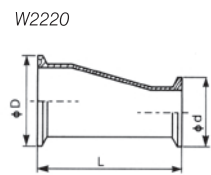
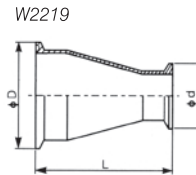

INCH 卡箍式大小头  
INCH Clamp Reducer

规格	D	d	L
0.75"/0.5"	50.5	25.4	53
1"/0.5"	50.5	25.4	55
1"/0.75"	50.5	50.5	55
1.25"/1"	50.5	50.5	58
1.5"/1"	50.5	50.5	64
1.5"/1.25"	50.5	50.5	64
2"/1"	64	50.5	82
2"/1.25"	64	50.5	82
2"/1.5"	64	50.5	64
2.5"/1"	77.5	50.5	82
2.5"/1.25"	77.5	50.5	82
2.5"/1.5"	77.5	50.5	82
2.5"/2"	77.5	64	64
3"/1"	91	50.5	99
3"/1.25"	91	64	99
3"/1.5"	91	50.5	99
3"/2"	91	64	82
3"/2.5"	91	77.5	64
4"/1.5"	119	50.5	129
4"/2"	119	64	129
4"/2.5"	119	77.5	112
4"/3"	119	91	94

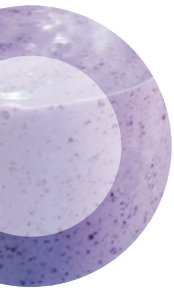

# 卫生级软管接头系列 Sanitary Hose Coupling

W2221

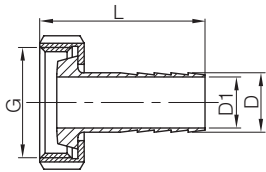

DIN 螺母式软管接头  
DIN Nut-type Hose Coupling

Size	D	D1	G	L
DN25	28	24	RD52×1/6	90
DN32	34	30	RD58×1/6	100
DN40	40	35	RD65×1/6	100
DN50	52	47	RD78×1/6	125
DN65	70	64	RD95×1/6	140
DN80	85	79	RD110×1/6	160
DN100	104	98	RD130×1/6	170

W2222

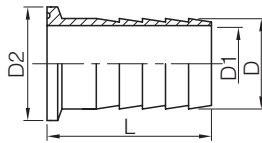

DIN 卡箍式软管接头  
DIN Clamp Hose Coupling

Size	D	D1	D2	L
DN25	28	24	50.5	89.5
DN32	34	30	50.5	96.5
DN40	40	35	50.5	96.5
DN50	52	47	64	118.5
DN65	70	64	91	136
DN80	85	79	106	151
DN100	104	98	119	154

W2223

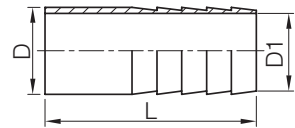

DIN 焊接式软管接头  
DIN Welded Hose Coupling

Size	D	D1	L
DN25	28	24	68
DN32	34	30	75
DN40	40	35	75
DN50	52	47	97
DN65	70	64	108
DN80	85	79	123
DN100	104	98	126

W2224

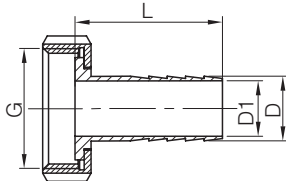

SMS 螺母式软管接头  
SMS Nut-type Hose Coupling

Size	D	D1	G	L
1"	25.4	20	RD40×1/6	90
1 1/4"	32	27	RD48×1/6	100
1 1/2"	38.1	33	RD60×1/6	100
2"	50.8	46	RD70×1/6	125
2 1/2"	63.5	57.5	RD85×1/6	140
3"	76.2	70	RD98×1/6	160
4"	101.6	96	RD132×1/6	170

W2225

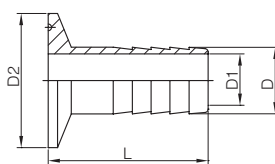

INCH 卡箍式软管接头  
INCH Clamp Hose Coupling

Size	D	D1	D2	L
1/4"	10	5	25.4	38
3/8"	11	6.2	25.4	38
1/2"	13.7	9.5	25.4	38
3/4"	21.4	15.8	25.4	38
1"	25.4	20.6	50.5	43
1 1/4"	31.8	26.8	50.5	43
1 1/2"	38.1	33.2	50.5	43
2"	50.8	46	64	58
2 1/2"	63.5	58.7	77.5	59
3"	76.2	71	91	78

W2226

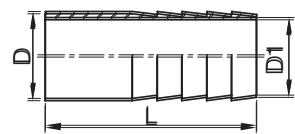

INCH 焊接式软管接头  
INCH Welded Hose Coupling

Size	D	D1	L
1/4"	10	5	25.3
3/8"	11	6.2	25.3
1/2"	13.7	9.5	25.3
3/4"	21.4	15.8	25.3
1"	25.4	20.6	30.3
1 1/4"	31.8	26.8	30.3
1 1/2"	38.1	33.2	30.3
2"	50.8	46	36.5
2 1/2"	63.5	58.7	37.5
3"	76.2	71	56.5
4"	101.6	96	63.5